

Hygiene guidelines for stand construction

As an exhibitor, you are obliged to implement and strictly adhere to the relevant safety and hygiene regulations at your stand. It is therefore advisable that you incorporate these measurements in your stand planning.

This is to give you and your stand constructor advance notification on the most important factors to consider for your stand planning. Please bear in mind that some of the regulations may be modified by October.

Recommendations and specifications for stand construction

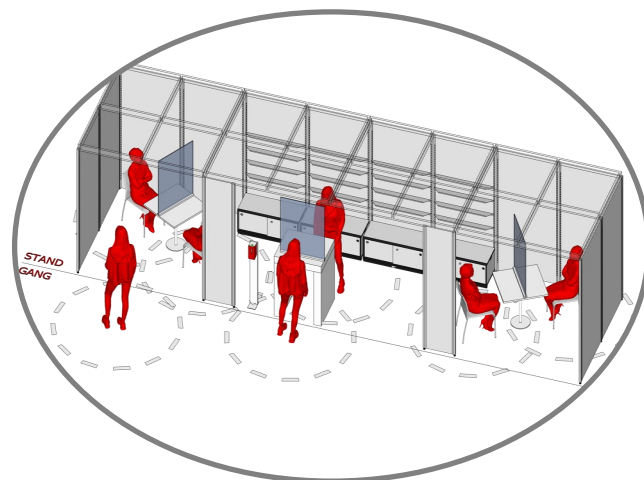
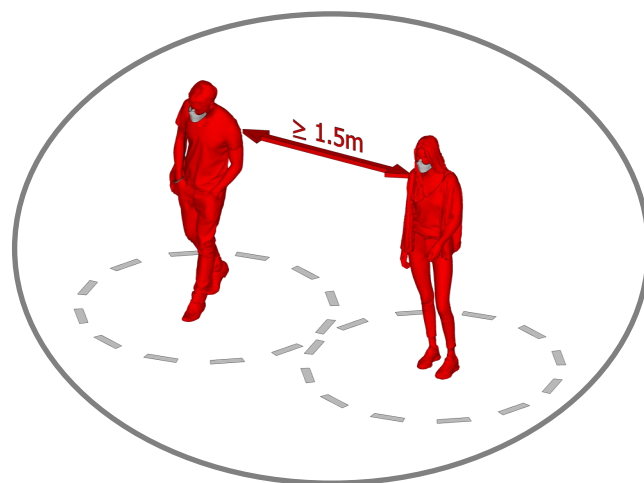

- Plan your stand generously enough to ensure that the required minimum social distancing (1.5 m) can be maintained at your stand at all times. Avoid construction bottlenecks.
- Upper floors must have staircases of sufficient width to accommodate opposing streams of visitors. Alternatively, one-way traffic must be arranged with separate staircases.
- Only so many people are permitted on the stand at the same time that the minimum distances are maintained at all times.
- Lectures and presentations can be held at the stand if the relevant safety and hygiene rules can be maintained. Clear directions for participants and seat allocation will be required.

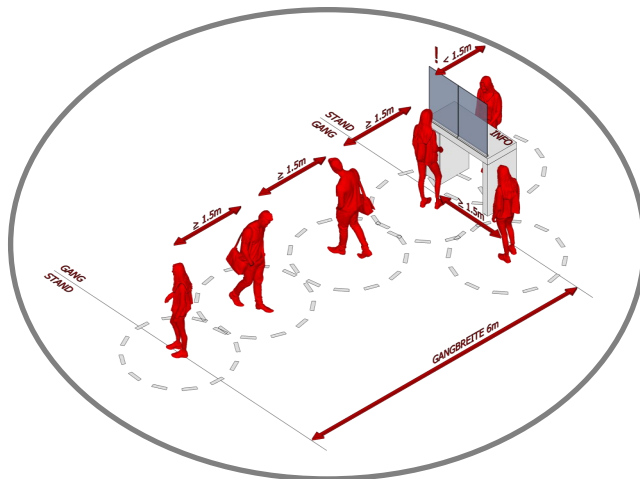
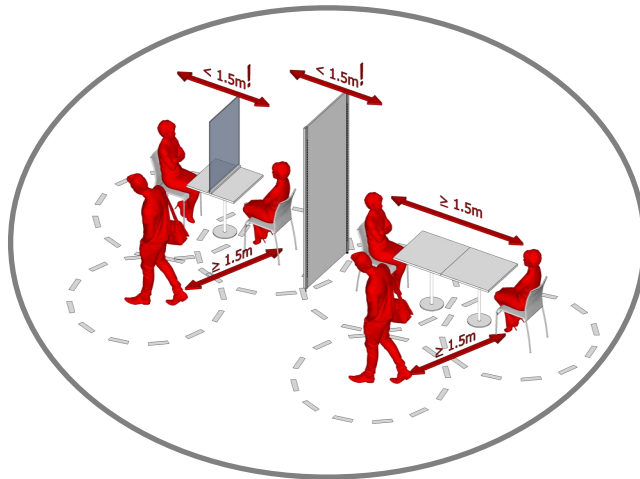
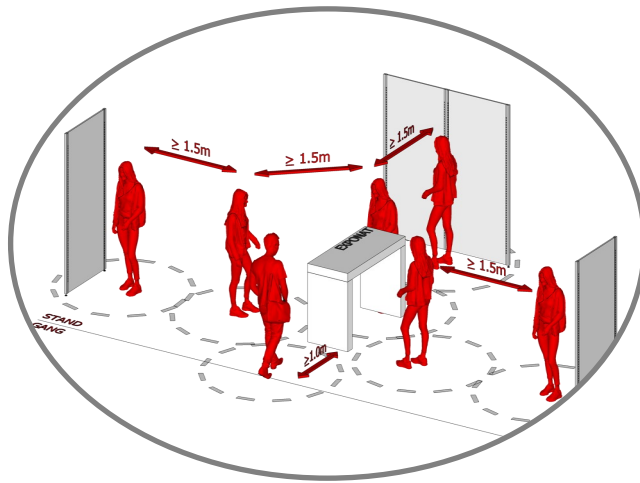

- Spaces around free-standing exhibits should have clear distancing markings to provide orientation for visitors.
- In meeting areas in particular please make sure there is adequate spacing between seats, e.g. by using larger or multiple tables.
- If this is not an option or if the minimum distance during personal contact cannot be upheld in certain areas (e.g. at info counters), please use suitable structural measures (e. g. acrylic protective screens).
If there is a general requirement to wear a face mask during the fair, this needs to be adhered to as well.
- **For system stands please note:** The tables and counters that you can order directly from us as part of furniture packages or via "Furniture & Extras" are not large enough to provide the required minimum distance.
We would therefore ask you to either use several tables for meeting, or to use a protective screen. You can book both through the [order form stand equipment and furnishings](#) from Messe Frankfurt Medien und Service GmbH (Deadline for booking: 28/9/2021).
- Make sure that directions on the stand are clearly marked, especially entrances and exists. Crowding is to be avoided at all costs.
- If exhibits, counters, displays, screens, etc are to be positioned close to the aisle within your stand please make sure that any crowding within the aisle is being avoided so that the required social distancing is maintained.
- Product presentations are not to be held at the edge of the stand to avoid crowding in the aisles.

Examples of stand construction and equipment in compliance with hygiene guidelines

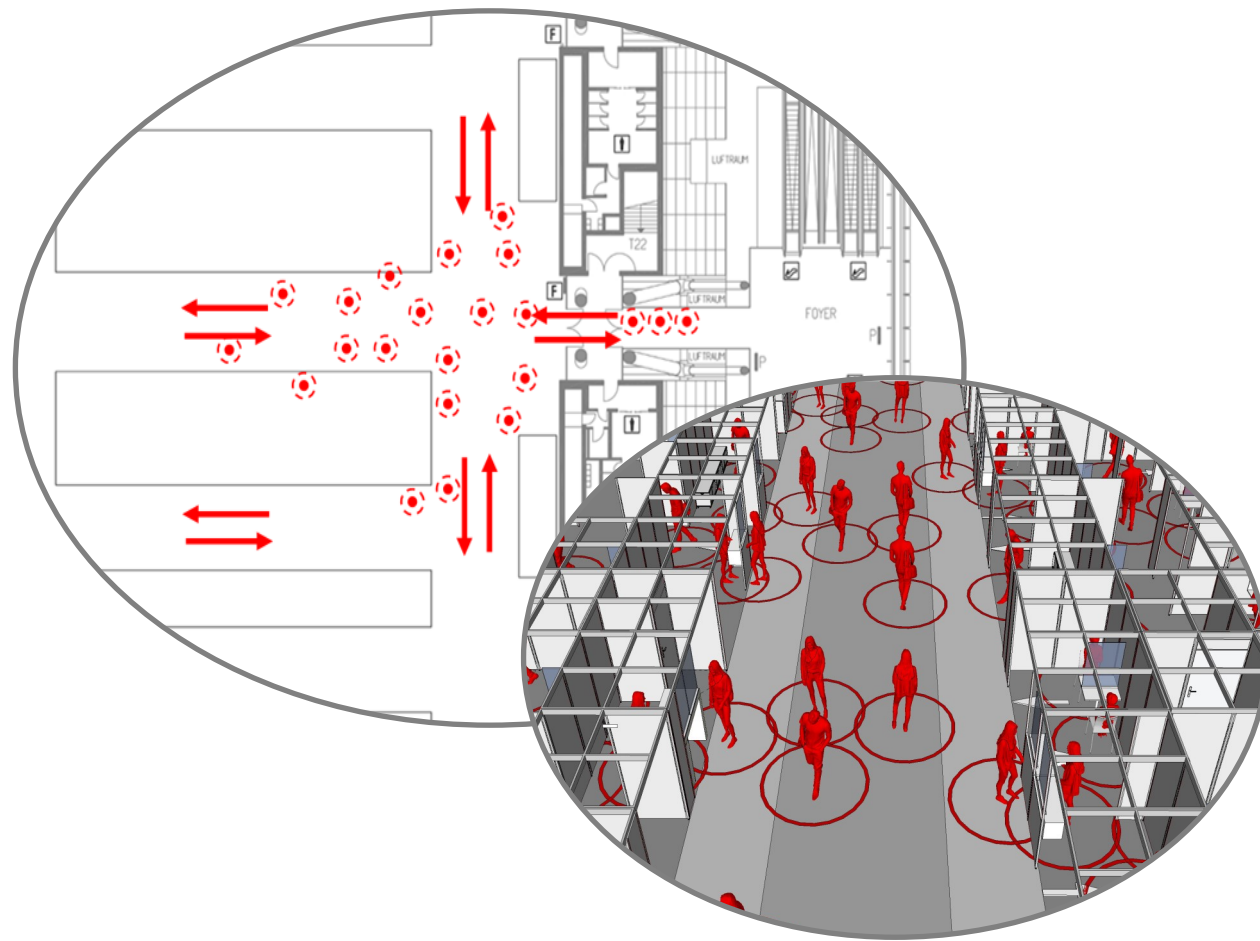

1.) Row stand 8 sqm (2 m x 4 m)

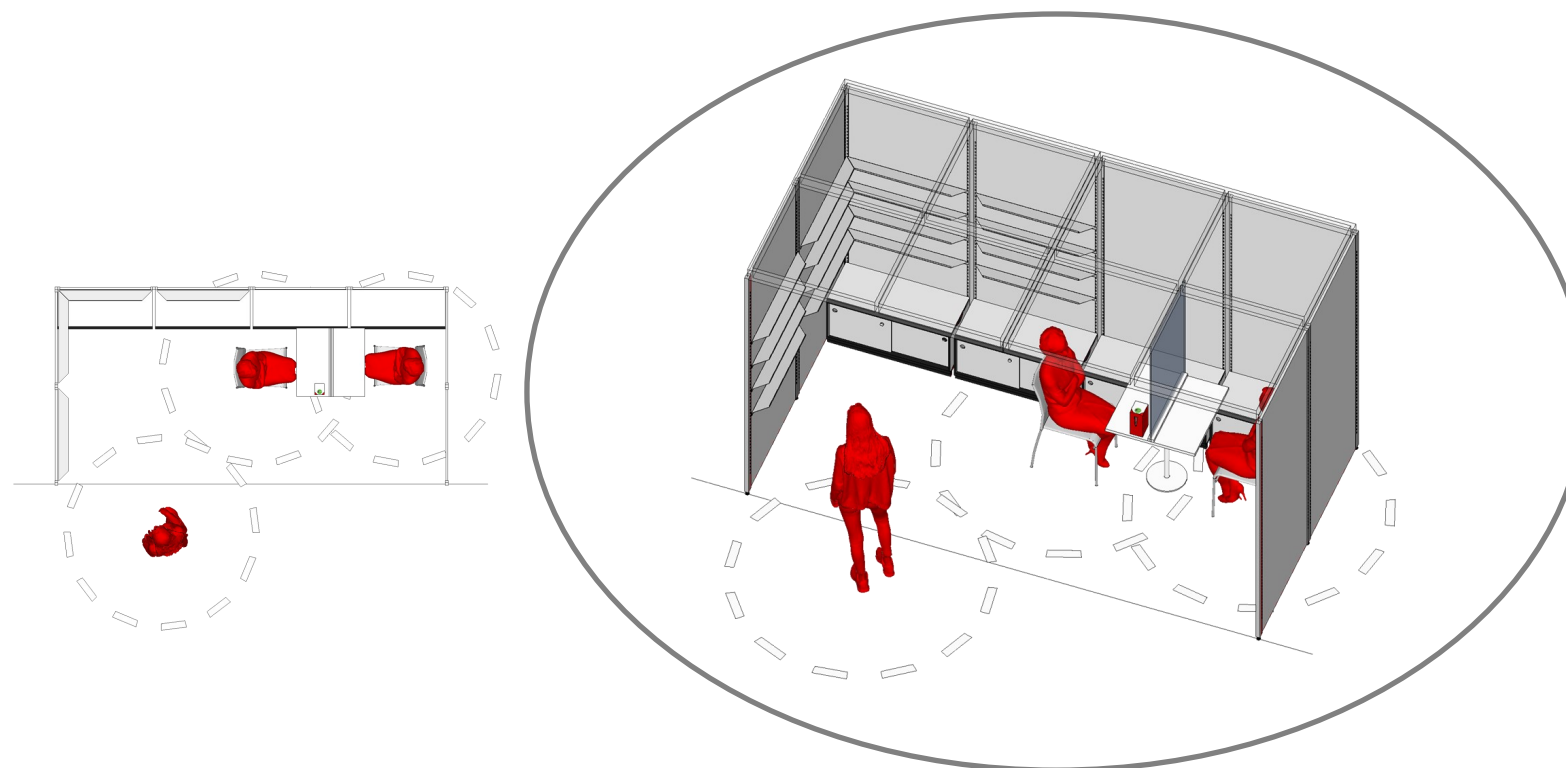

- 2 bench cabinets
- 16 book shelves
- 1 table, 2 chairs, 4 spotlights (= package M)
+ protective screen (which can be booked via the service contractor)

max. number of people on the stand: 2

2.) Row stand 8 sqm (2 m x 4 m)

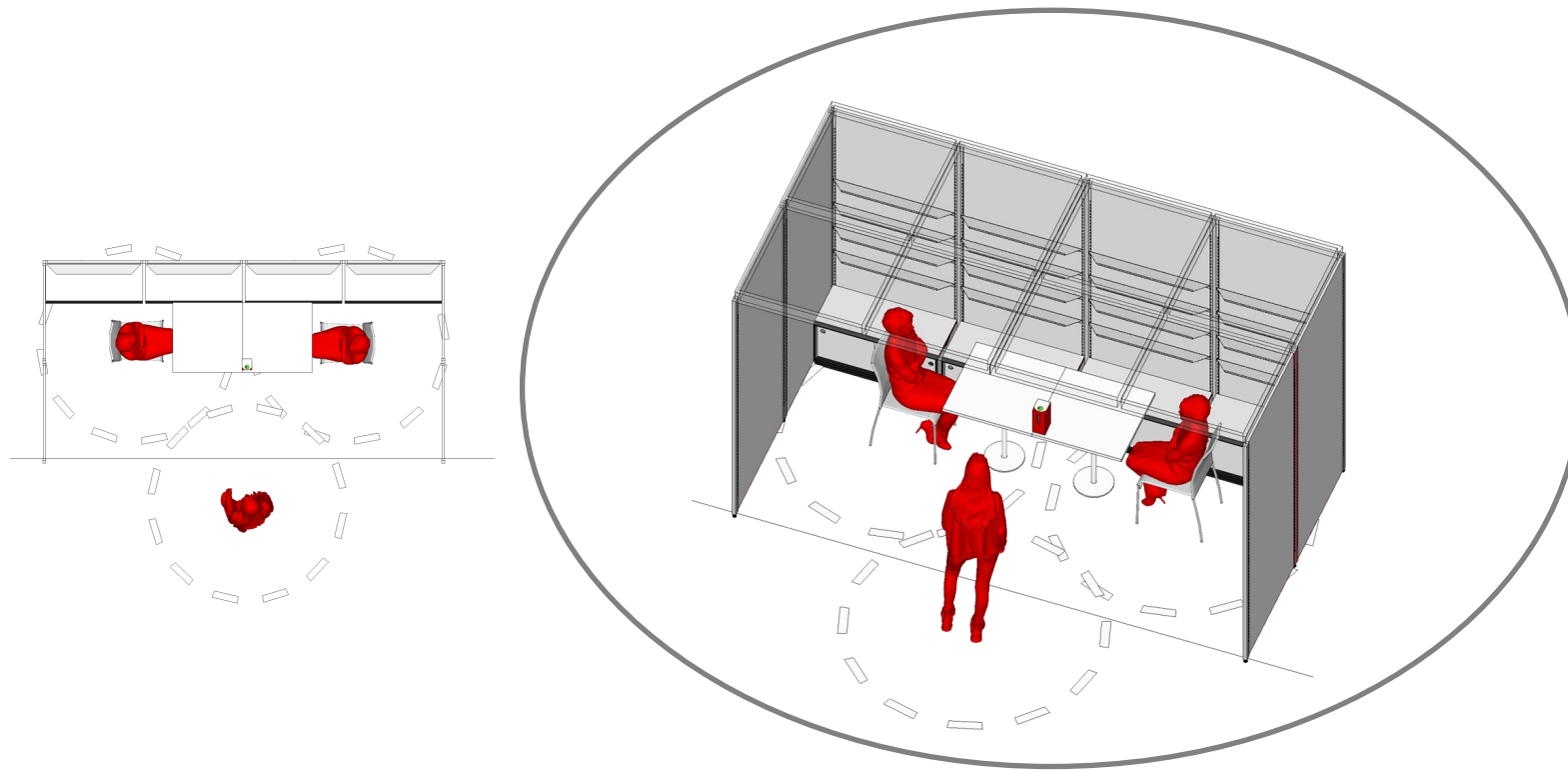

- 4 bench cabinets
- 16 book shelves
- 1 table with 2 chairs, 4 spot lights (= package M)
+ 1 additional table (which can be booked via the service contractor)

max. number of people on the stand: 2

3.) Row stand 12 sqm (2 m x 6 m) with a 1 m x 1 m cubicle

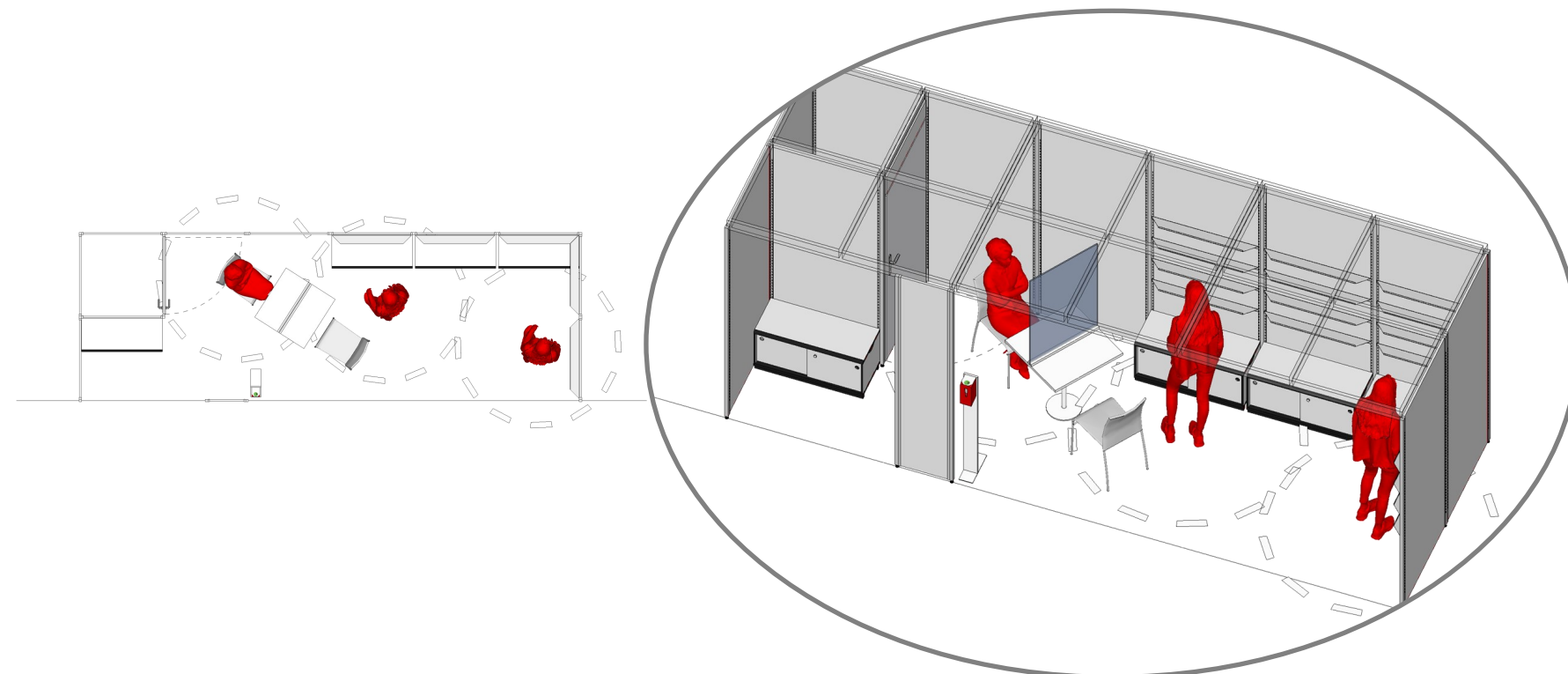

- 4 bench cabinets
- 20 book shelves
- 1 cubicle 1 m x 1 m (= furniture & extras)
- 1 table with 2 chairs, 4 spotlights (= package M)
+ protective screen (which can be booked via the service contractor)
+ 2 additional spotlights (= package XS)

max. number of people on the stand: 3

4.) Row stand 12 sqm (2 m x 6 m)

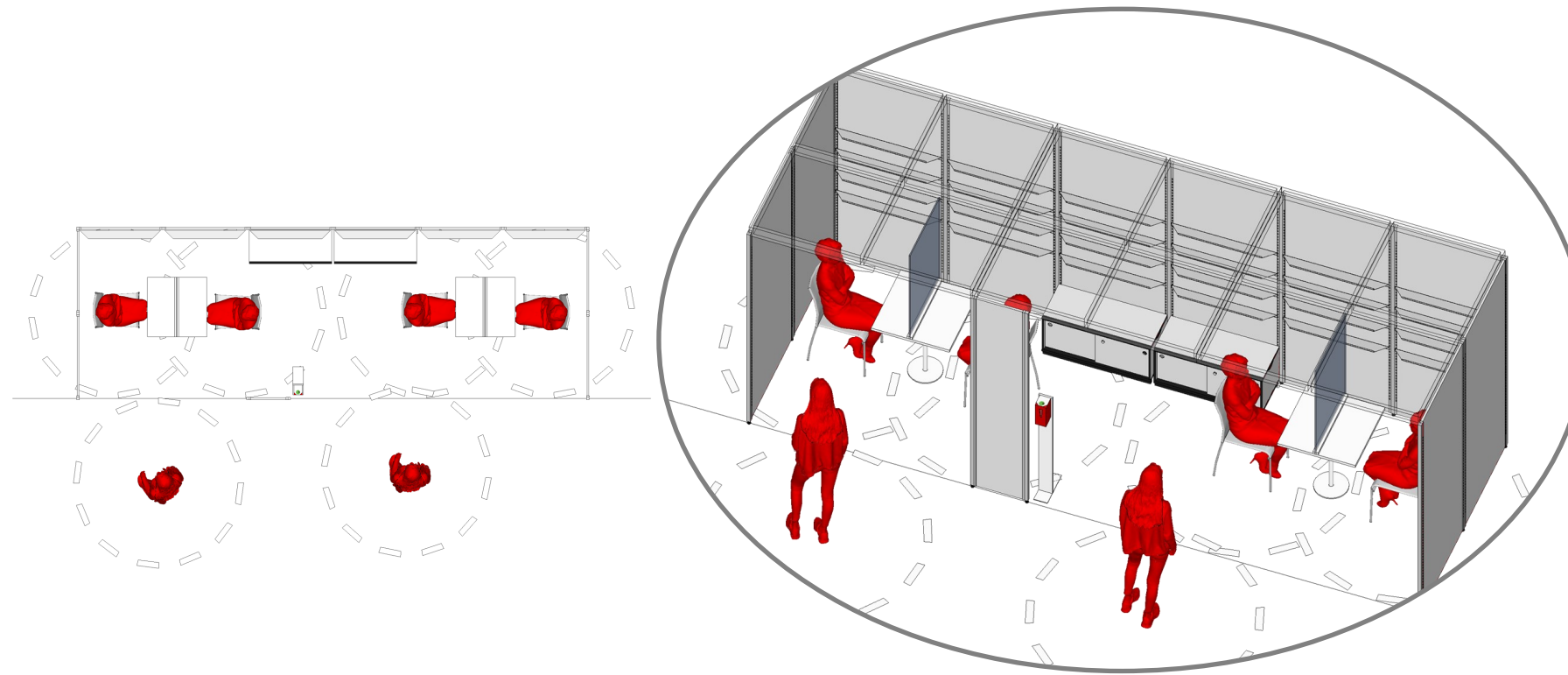

- 2 bench cabinets
- 24 book shelves
- 2 tables with 2 chairs each and 6 spotlights (= package L)
+ 1 protective screen (which can be booked via the service contractor)

max. number of people on the stand: 4

5.) Corner stand 16 sqm (2 m x 8 m)

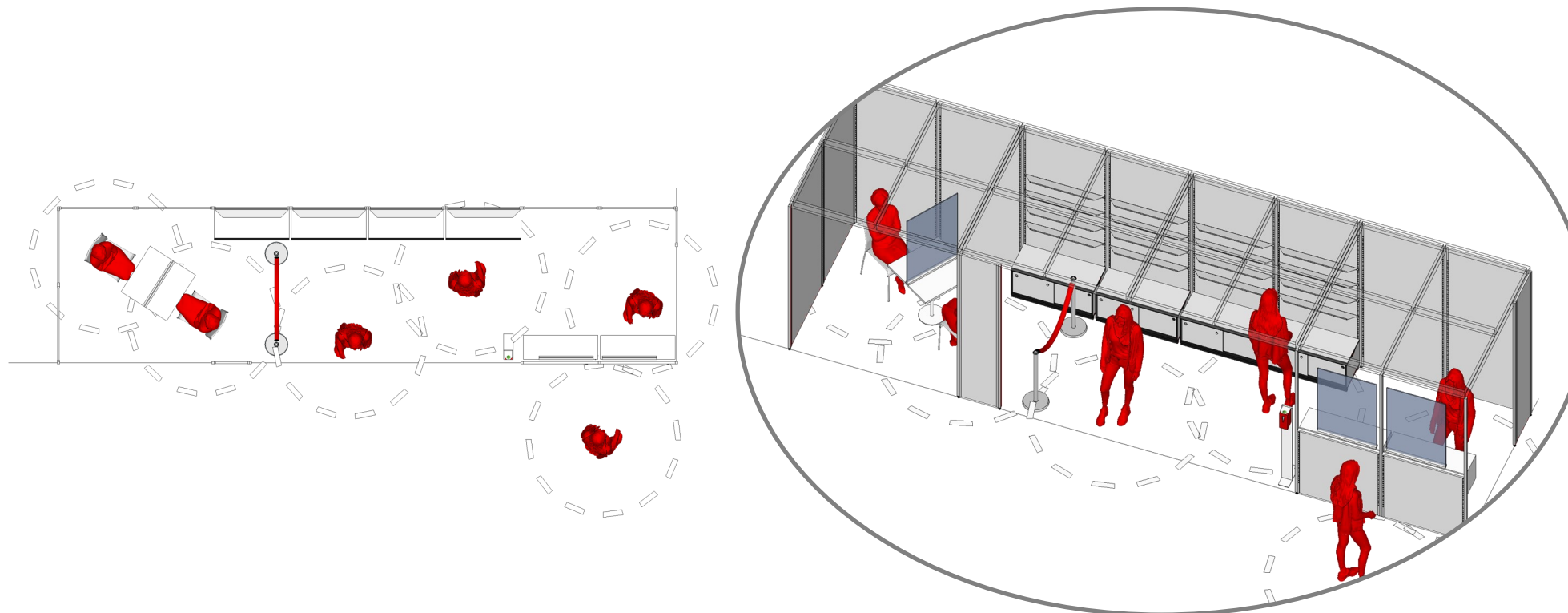

- 4 bench cabinets
- 16 book shelves
- 1 half-open wall (2 m) with a hanging shelf that can be used as a reception/counter
+ 2 protective screens (which can be booked via the service contractor)
- 1 table with 2 chairs and 4 spotlights (= package M)
+ 1 protective screen (which can be booked via the service contractor)
+ 4 additional spotlights (= 2 x package XS)

max. number of people on the stand: 5

6.) Row stand 16 sqm (2 m x 8 m)

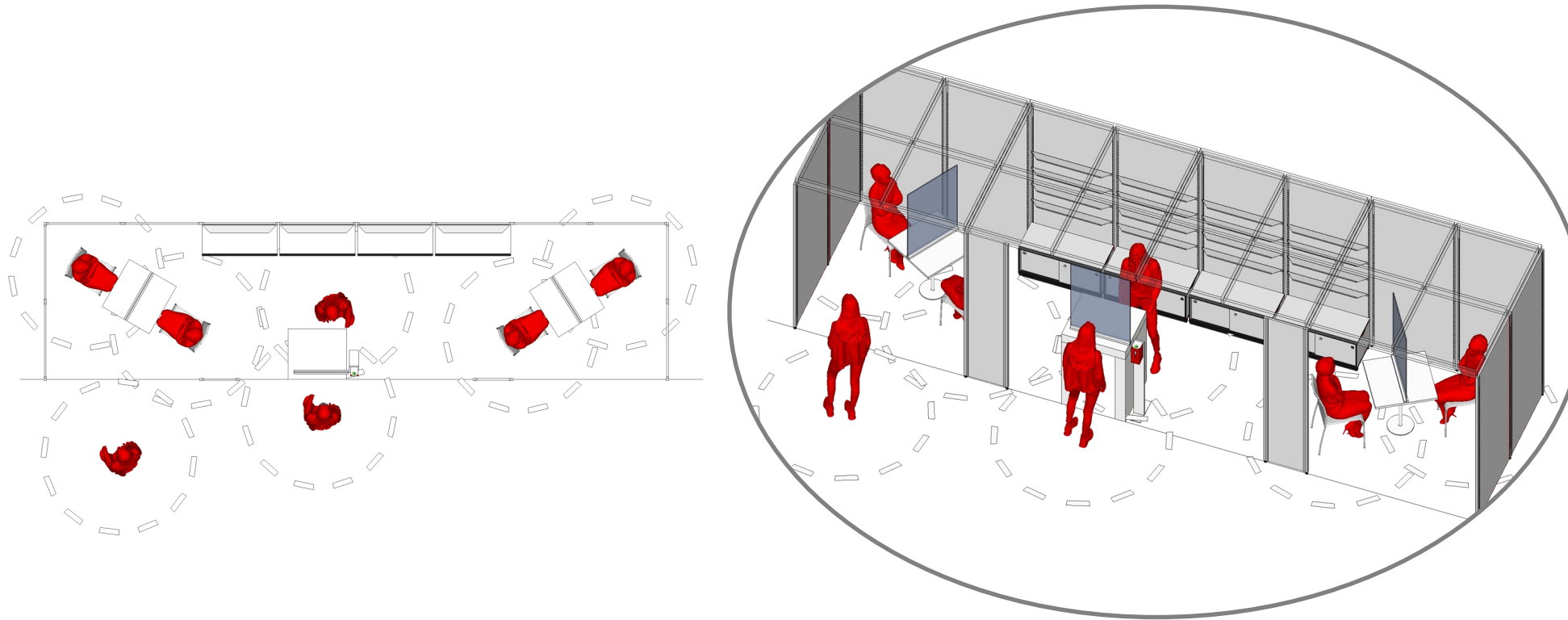

- 4 bench cabinets
- 16 book shelves
- 1 counter 0.75 m (furniture & extras)
+ 1 protective screen (which can be booked via the service contractor)
- 2 tables with 2 chairs each, 8 spotlights (= package XL)
+ 2 protective screens (which can be booked via the service contractor)

max. number of people on the stand: 5

7.) Corner stand 16 sqm (4 m x 4 m)

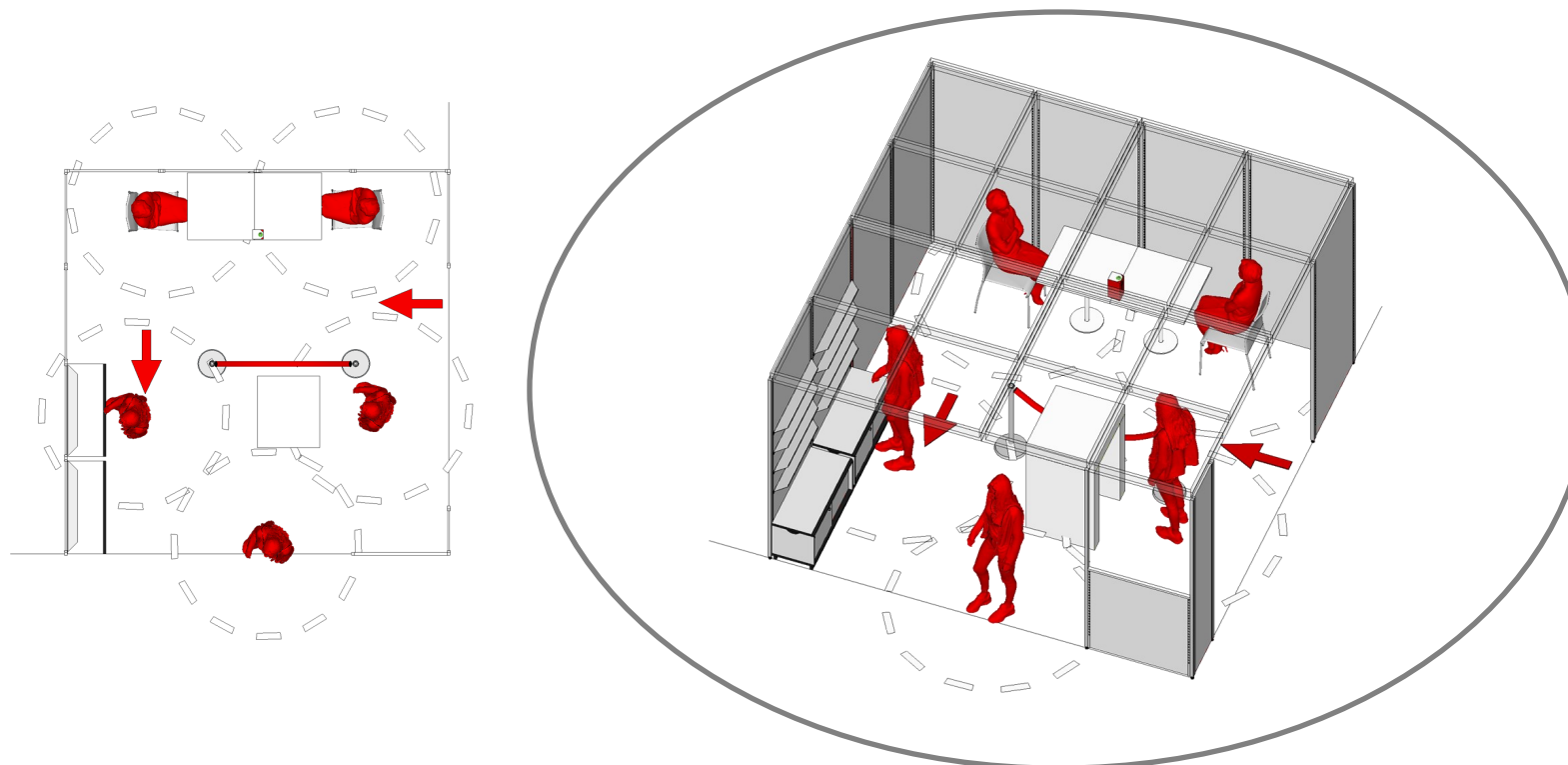

- 2 bench cabinets
- 8 book shelves
- 1 table with 2 chairs, 4 spotlights (= package M)
+ 1 additional table (can be ordered via the service contractors)
+ 4 additional spotlights (= 2x package XS)
- 1 counter 0.5 m for book presentations (furniture & extras)
- Marking of stand entrance and exit (via floor markings or signage)

max. number of people on the stand: 5

8.) Row stand 16 sqm (4 m x 4 m)

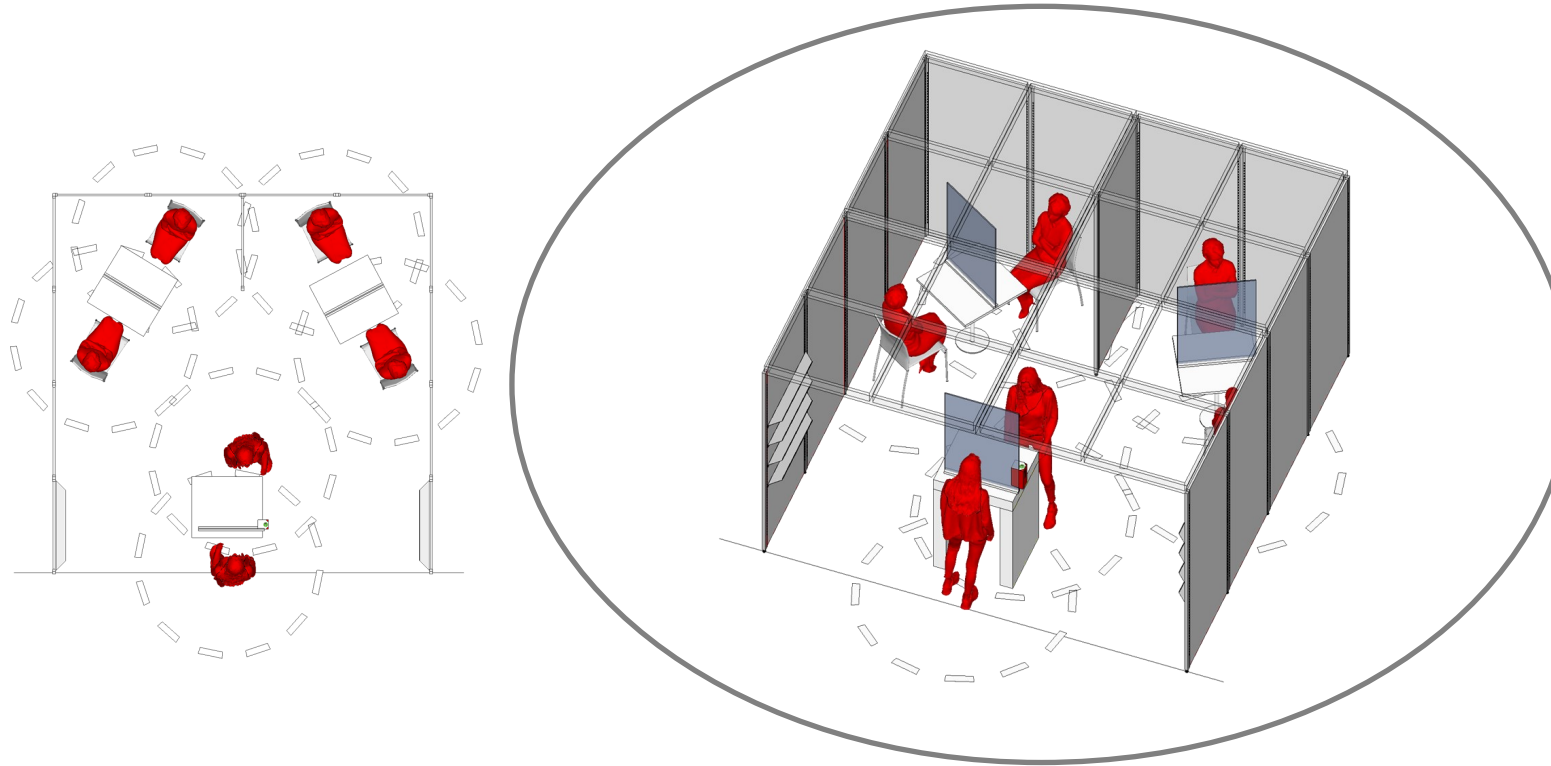

- 8 book shelves
- 1 counter 0.75 m (furniture & extras)
+ 1 protective screen (which can be booked via the service contractor)
- 2 tables with 2 chairs each, 8 spotlights (= package XL)
+ 2 protective screens (which can be booked via the service contractor)

max. number of people on the stand: 5

9.) Row stand 20 sqm (2 m x 10 m)

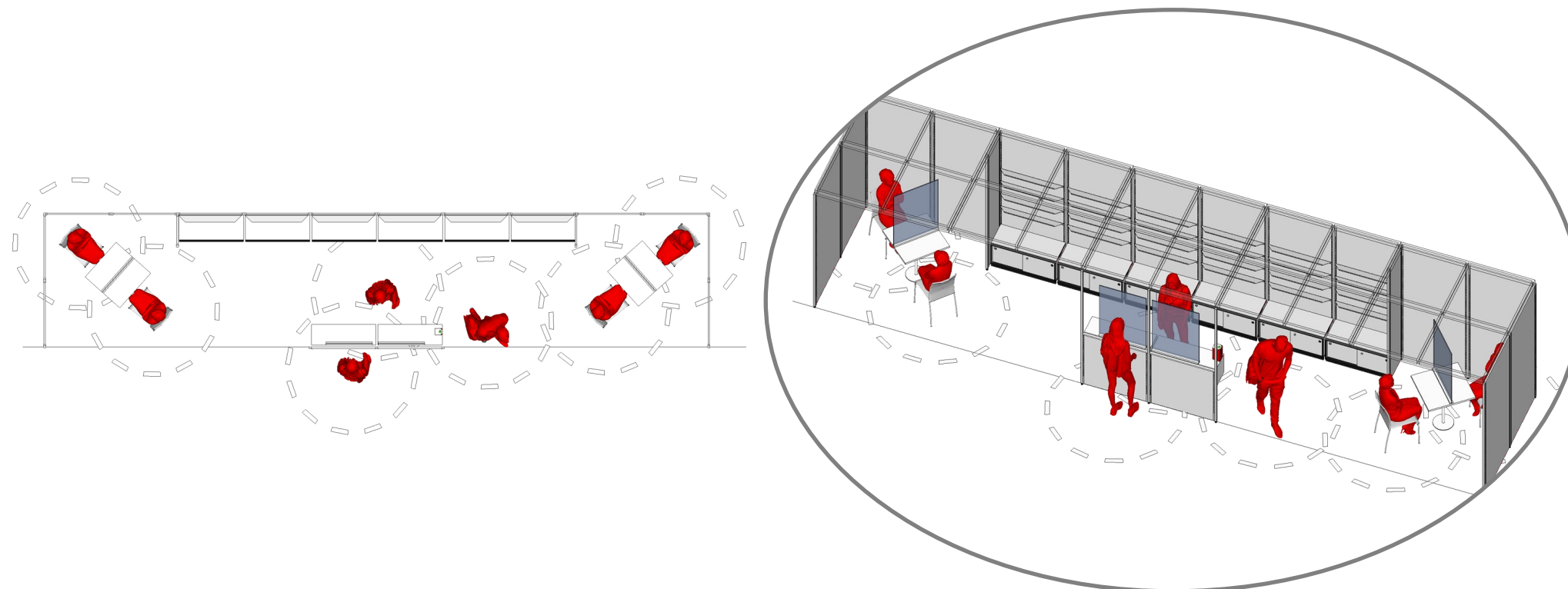

- 6 bench cabinets
- 24 book shelves
- 1 half-open wall (2 m) with a hanging shelf that can be used
as a reception/counter (furniture & extras)
+ 2 protective screens (which can be booked via the service contractor)
- 2 tables with 2 chairs each, 8 spotlights (= package XL)
+ 2 protective screens (which can be booked via the service contractor)
+ 2 additional spotlights (= package XS)

max. number of people on the stand: 6

10.) Row stand 20 sqm (2 m x 10 m)

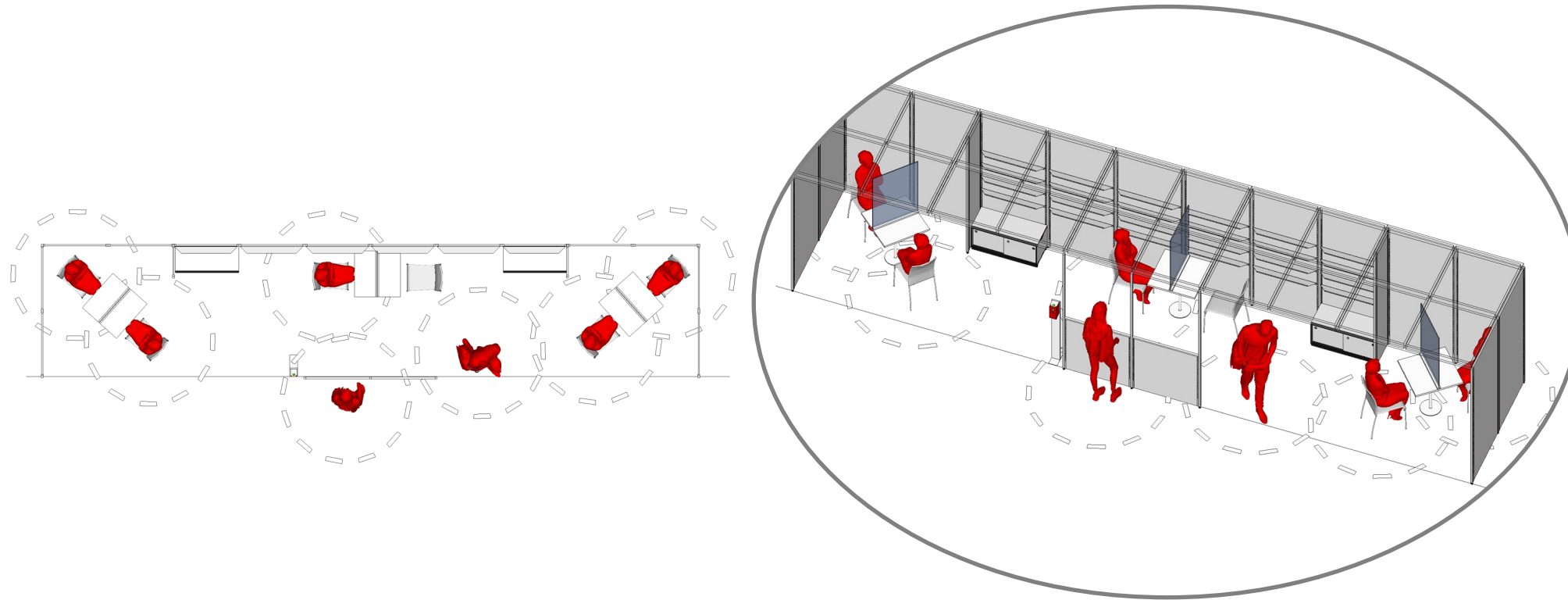

- 2 bench cabinets
- 24 book shelves
- 3 tables with 2 chairs each, 10 spotlights (= package XXL)
+ 3 protective screens (which can be booked via the service contractor)

max. number of people on the stand: 6

11.) Corner stand 24 sqm (2 m x 12 m) with 2 m x 2 m cubicle

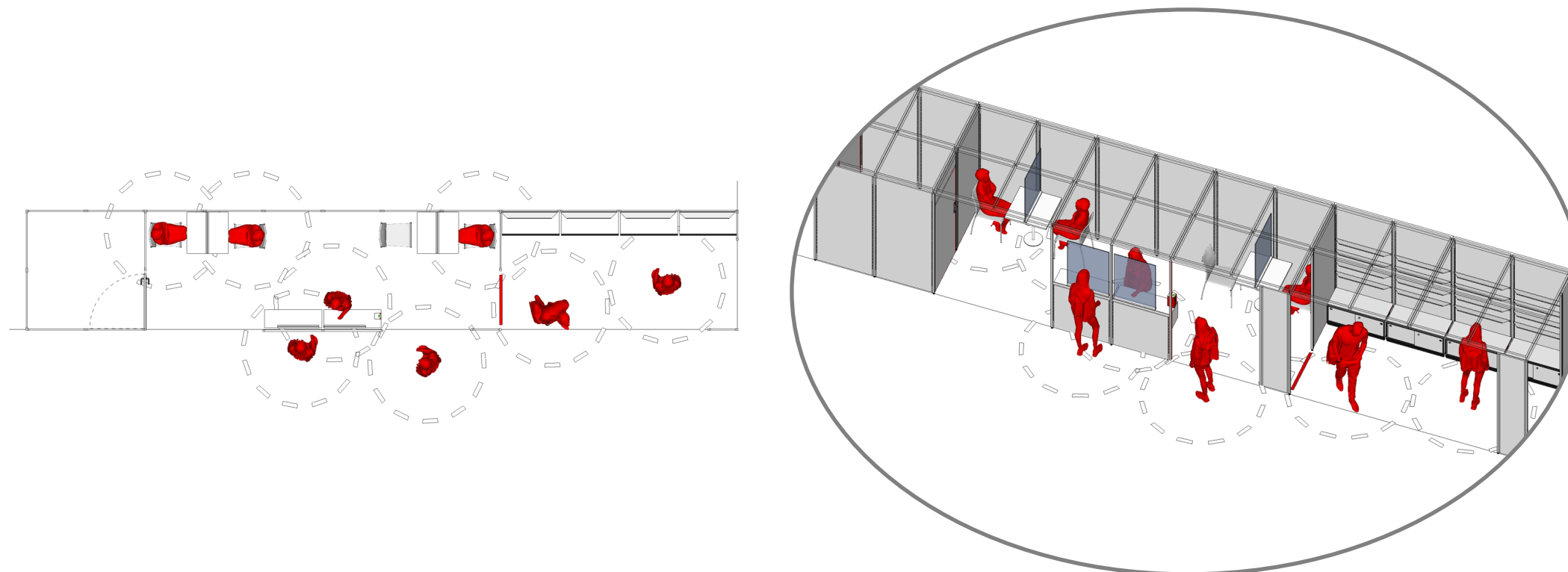

- 4 bench cabinets
- 16 book shelves
- 1 cubicle 2 m x 2 m (furniture & extras)
- 1 half-open wall (2 m) with a hanging shelf that can be used
as a reception/counter (furniture & extras)
+ 2 protective screens (which can be booked via the service contractor)
- 2 tables with 2 chairs each, 8 spotlights (= package XL)
+ 2 protective screens (which can be booked via the service contractor)
+ 4 additional spotlights (= 2x package XS)

max. number of people on the stand: 5

12.) Corner stand 32 sqm (4 m x 8 m)

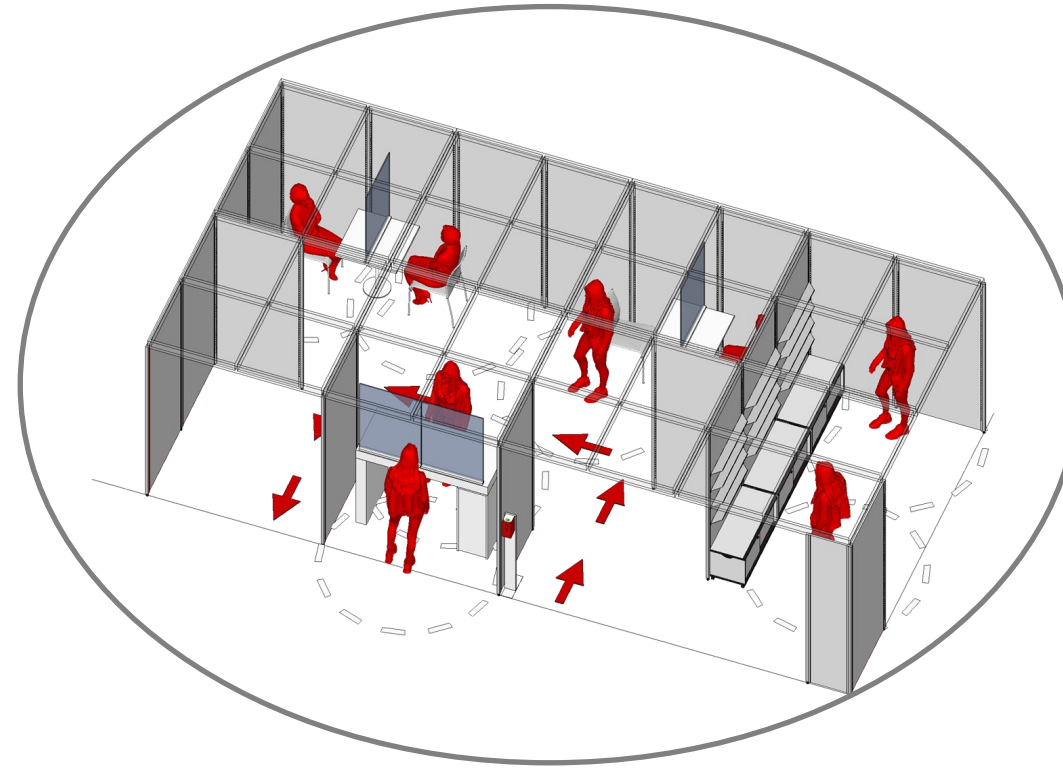
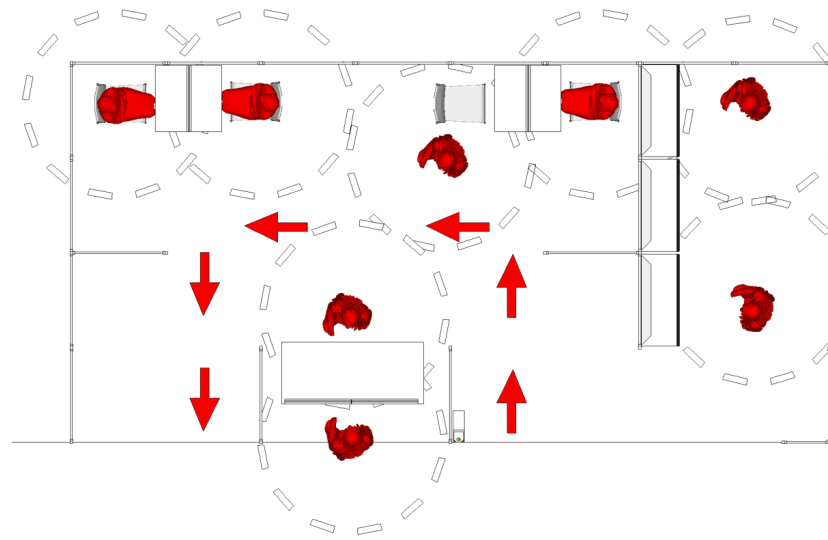

- 3 bench cabinets
- 12 book shelves
- 1 counter 1.5 m (furniture & extras)
+ 2 protective screens (which can be booked via the service contractor)
- 2 tables with 2 chairs each, 8 spotlights (= package XL)
+ 2 protective screens (which can be booked via the service contractor)
+ 8 additional spotlights (= 4x package XS)
- Marking of stand entrance and exit (via floor markings or signage)

max. number of people on the stand: 9

13.) Row stand 32 sqm (4 m x 8 m)

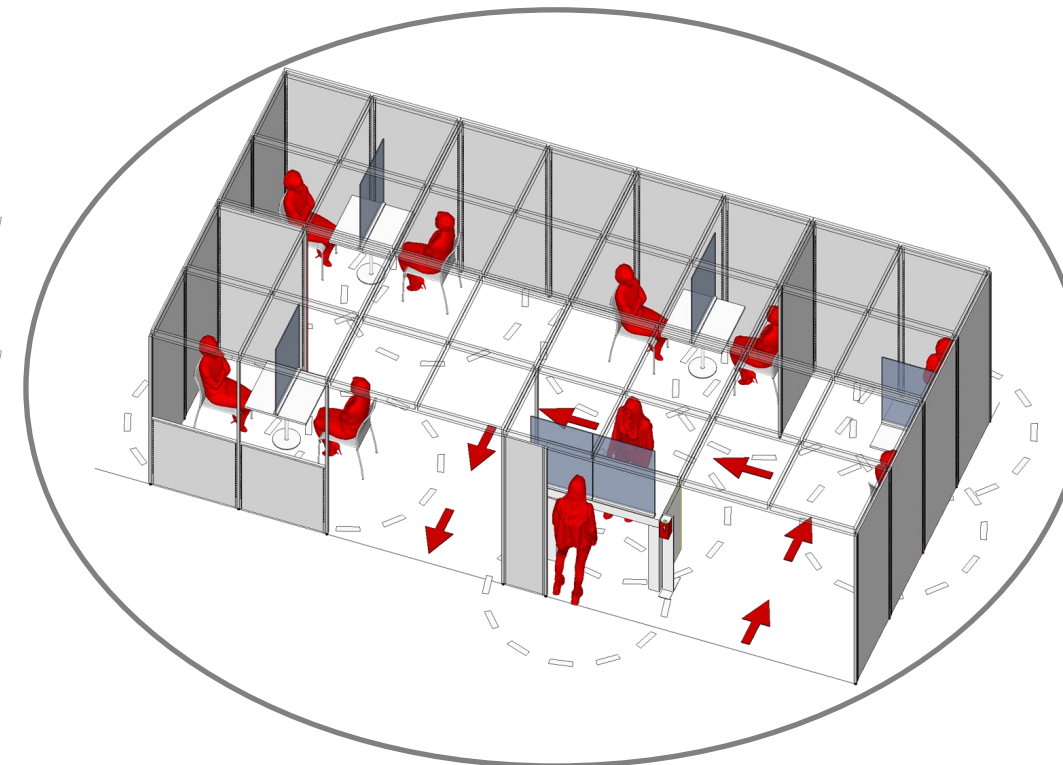
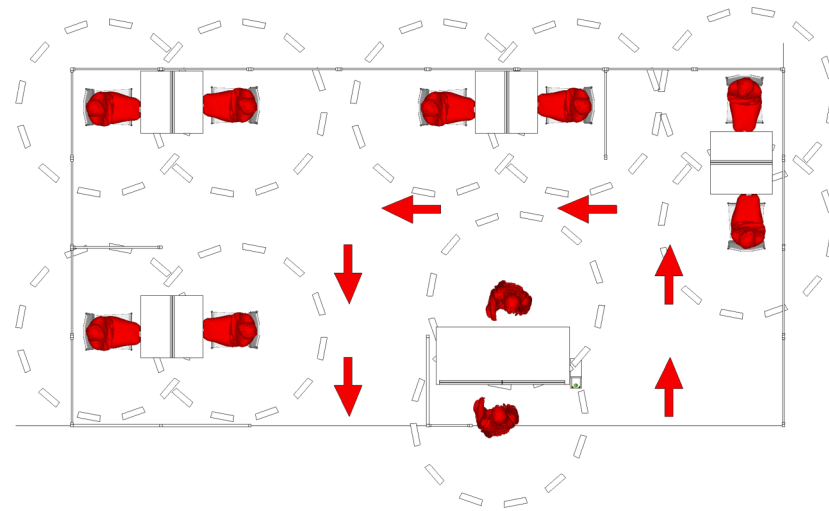

- 1 counter 1.5 m (furniture & extras)
+ 2 protective screens (which can be booked via the service contractor)
- 3 tables with 2 chairs each, 10 spotlights (= package XXL)
+ 1 table with 2 chairs, 4 spotlights (= package M)
+ 4 protective screens (which can be booked via the service contractor)
+ 2 additional spotlights (= package XS)
- Marking of stand entrance and exit (via floor markings or signage)

max. number of people on the stand: 9

14.) Row stand 40 sqm (4 m x 10 m) with 2 m x 2 m cubicle

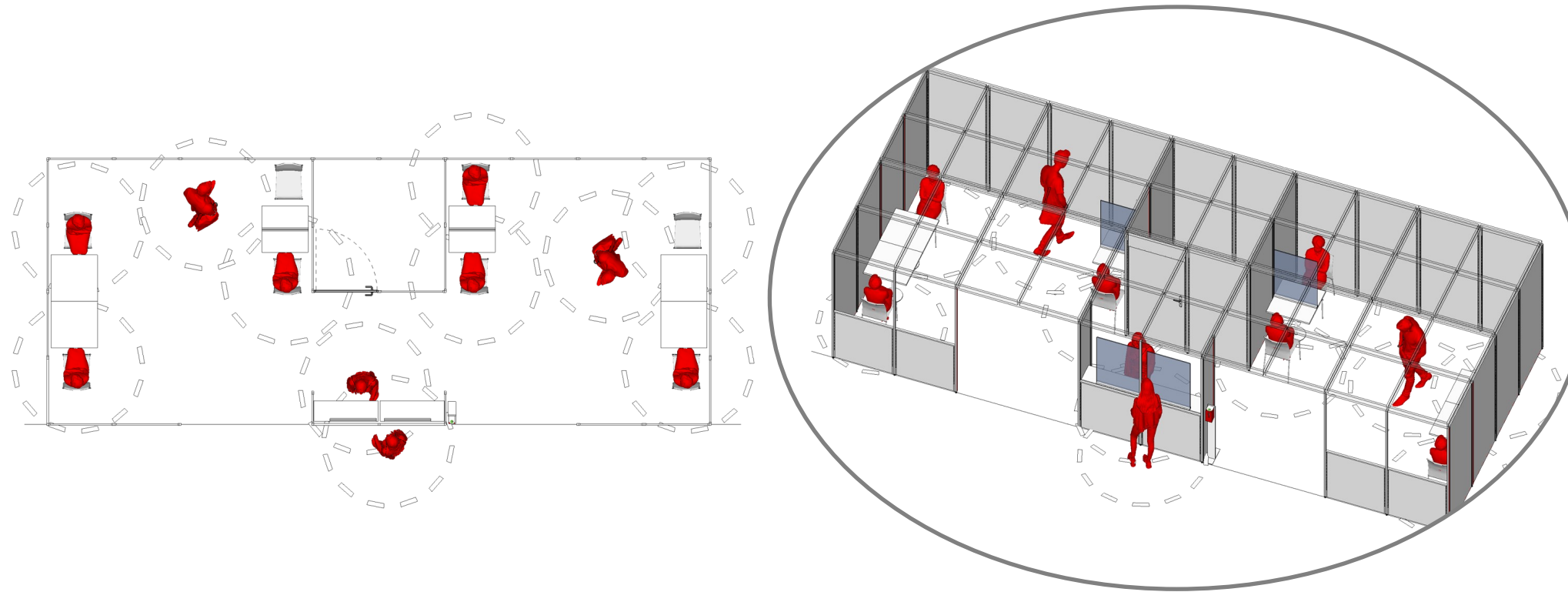

- 1 cubicle 2 m x 2 m (furniture & extras)
- 1 half-open wall (2 m) with a hanging shelf that can be used as a reception/counter (furniture & extras)
+ 2 protective screens (which can be booked via the service contractor)
- 4 tables with 2 chairs each, 16 spotlights (= 2x package XL)
+ 2 protective screens (which can be booked via the service contractor)
+ 4 additional spotlights (= 2x package XS)

max. number of people on the stand: 10

15.) Row stand 56 sqm (4 m x 14 m) with 2 m x 2 m cubicle

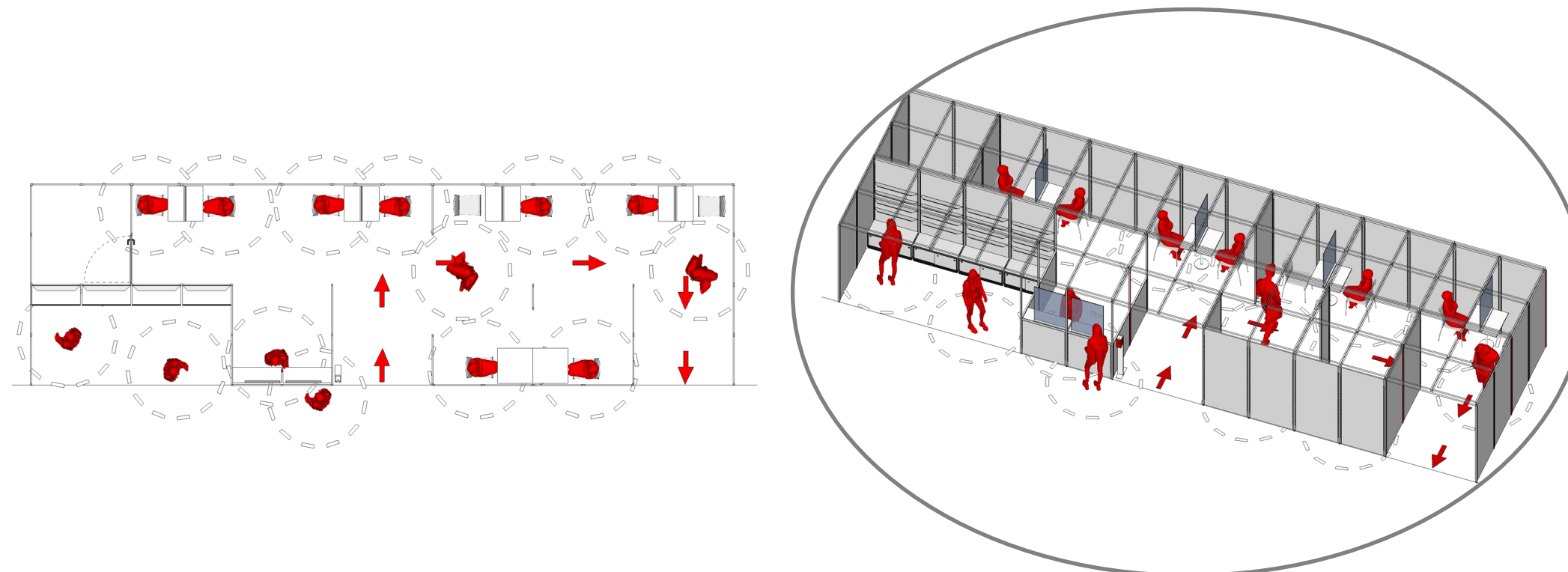

- 4 bench cabinets, 16 book shelves
- 1 cubicle 2 m x 2 m (furniture & extras)
- 1 half-open wall (2 m) with a hanging shelf that can be used as a reception/counter (furniture & extras)
+ 2 protective screens (which can be booked via the service contractor)
- 3 tables with 2 chairs each, 10 spotlights (= package XXL)
+ 2 tables with 2 chairs each, 8 spotlights (= package XL)
+ 1 additional table (can be ordered via the service contractors)
+ 4 protective screens (which can be booked via the service contractor)
+ 10 additional spotlights (= 5x package XS)
- Marking of stand entrance and exit (via floor markings or signage)

max. number of people on the stand: 15

16.) Row stand 56 sqm (4 m x 14 m) with 2 m x 2 m cubicle

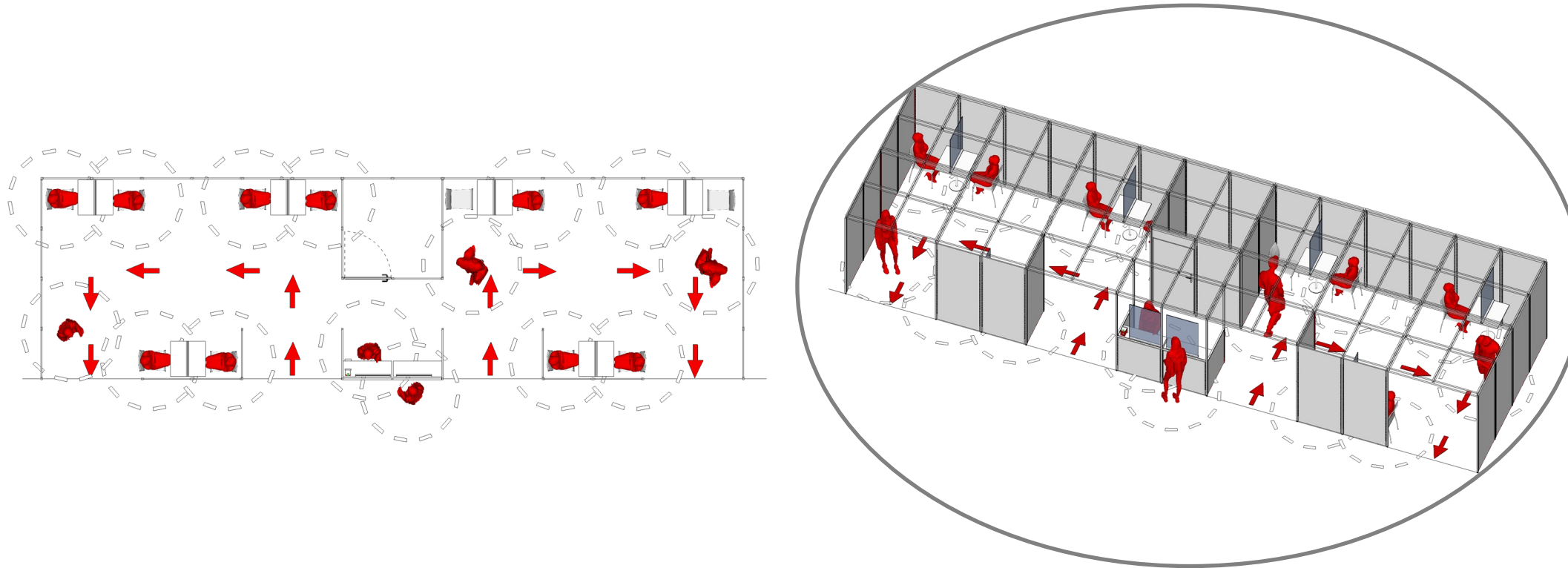

- 1 cubicle 2 m x 2 m (furniture & extras)
- 1 half-open wall (2 m) with a hanging shelf that can be used as a reception/counter (furniture & extras)
+ 2 protective screens (which can be booked via the service contractor)
- 6 tables with 2 chairs each, 20 spotlights (= 2x package XXL)
+ 6 protective screens (which can be booked via the service contractor)
+ 8 additional spotlights (= 4x package XS)
- Marking of stand entrance and exit (via floor markings or signage)

max. number of people on the stand: 15

17.) Walk-through stand 60 qm (6 m x 10 m) with 2 m x 2 m cubicle

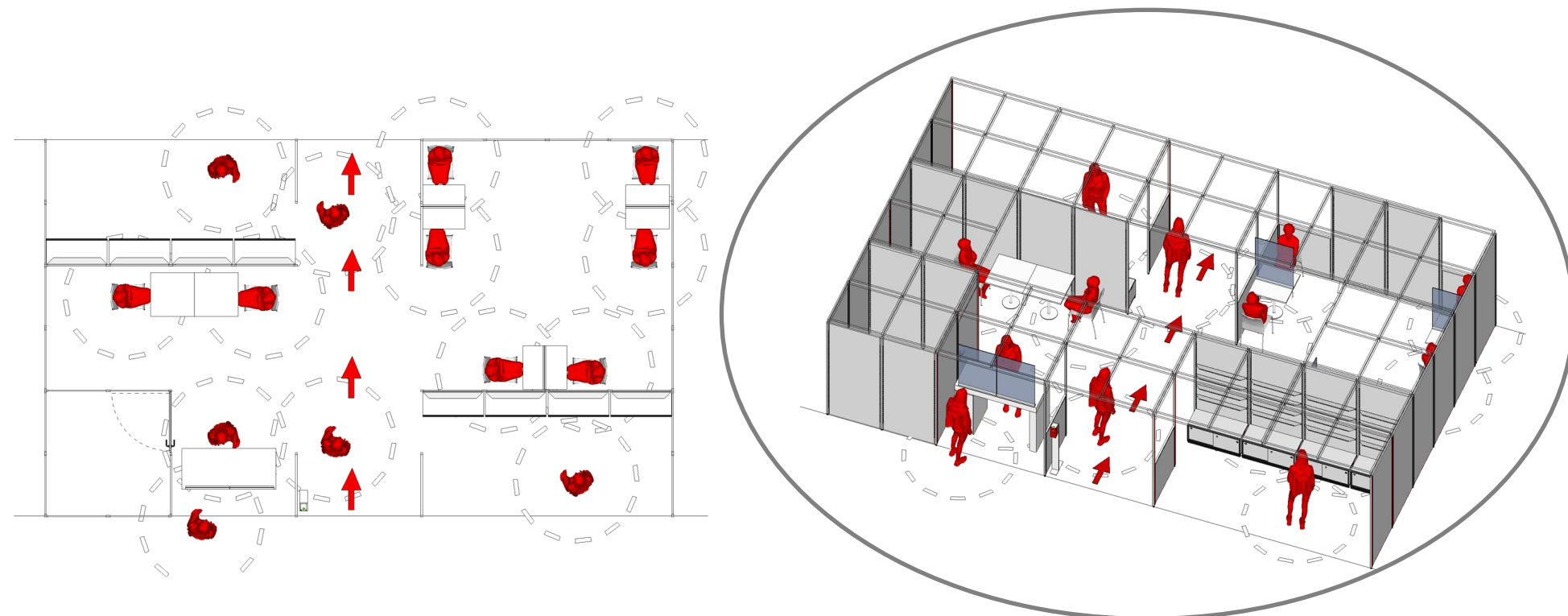

- 8 bench cabinets
- 32 book shelves
- 1 cubicle 2 m x 2 m (furniture & extras)
- 1 counter 1.5 m (furniture & extras)
+ 2 protective screens (which can be booked via the service contractor)
- 3 tables with 2 chairs each, 10 spotlights (= package XXL)
+ 1 table with 2 chairs, 4 spotlights (= package M)
+ 1 additional table (can be ordered via the service contractors)
+ 3 protective screens (which can be booked via the service contractor)
+ 10 additional spotlights (= 5x package XS)
- Marking of stand entrance and exit (via floor markings or signage)

max. number of people on the stand: 16

18.) Corner stand 72 sqm (6 m x 12 m) with 2 m x 2 m cubicle

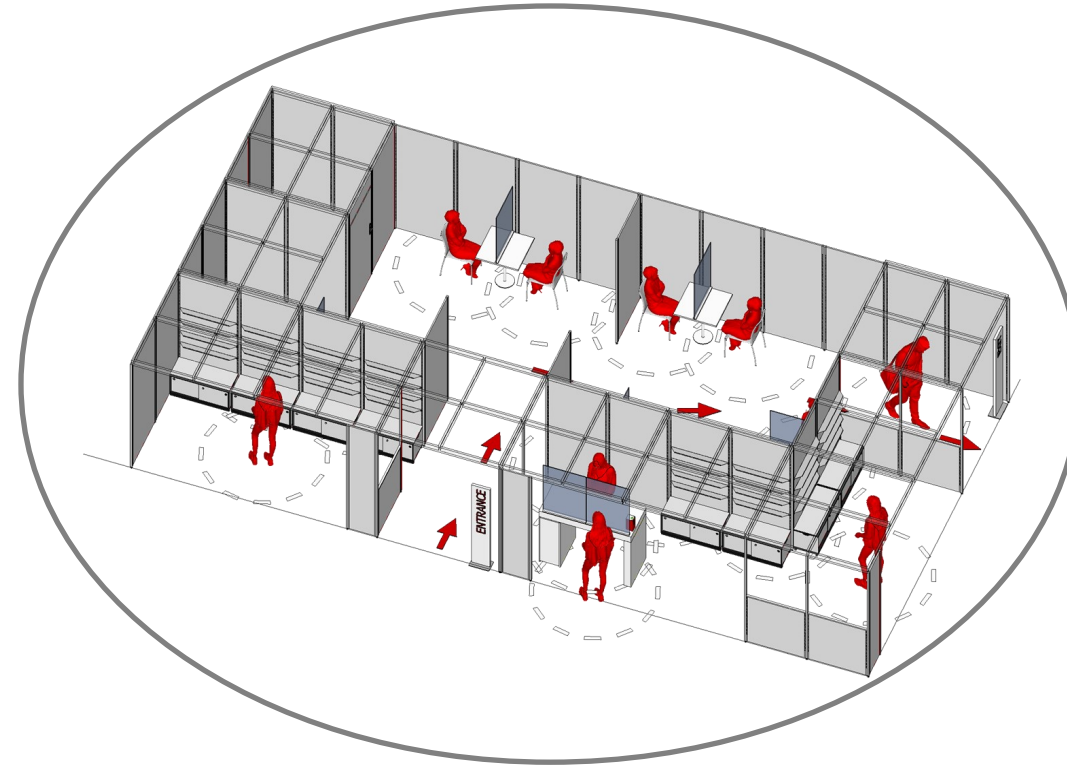
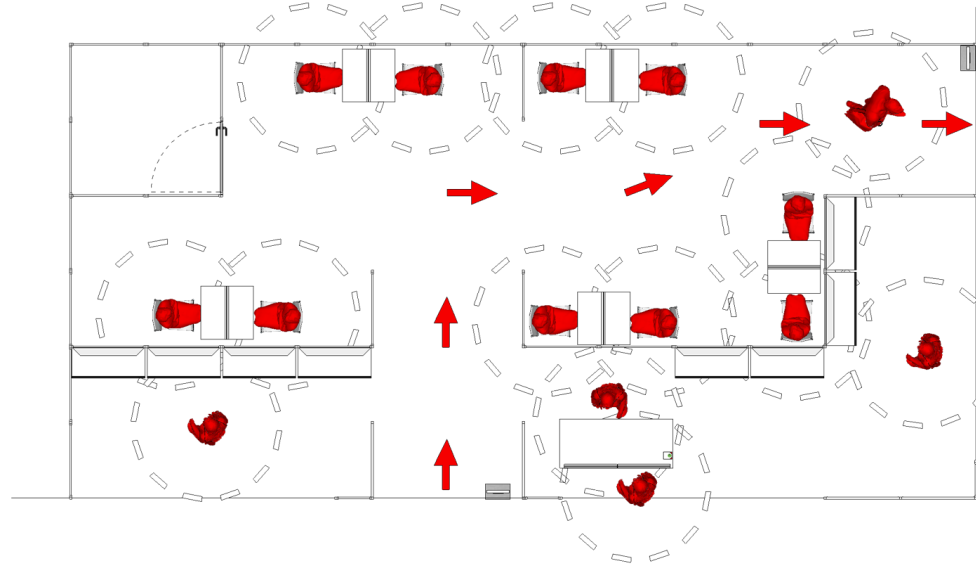

- 1 cubicle 2 m x 2 m (furniture & extras)
- 1 counter 1.5 m (furniture & extras)
+ 2 protective screens (which can be booked via the service contractor)
- 3 tables with 2 chairs each, 10 spotlights (= package XXL)
+ 2 tables with 2 chairs each, 8 spotlights (= package XL)
+ 5 protective screens (which can be booked via the service contractor)
+ 2 additional spotlights (= package XS)
- Marking of stand entrance and exit (via floor markings or signage)

max. number of people on the stand: 19

19.) Walk-through stand 80 sqm (8 m x 10 m) with 2 m x 2 m cubicle

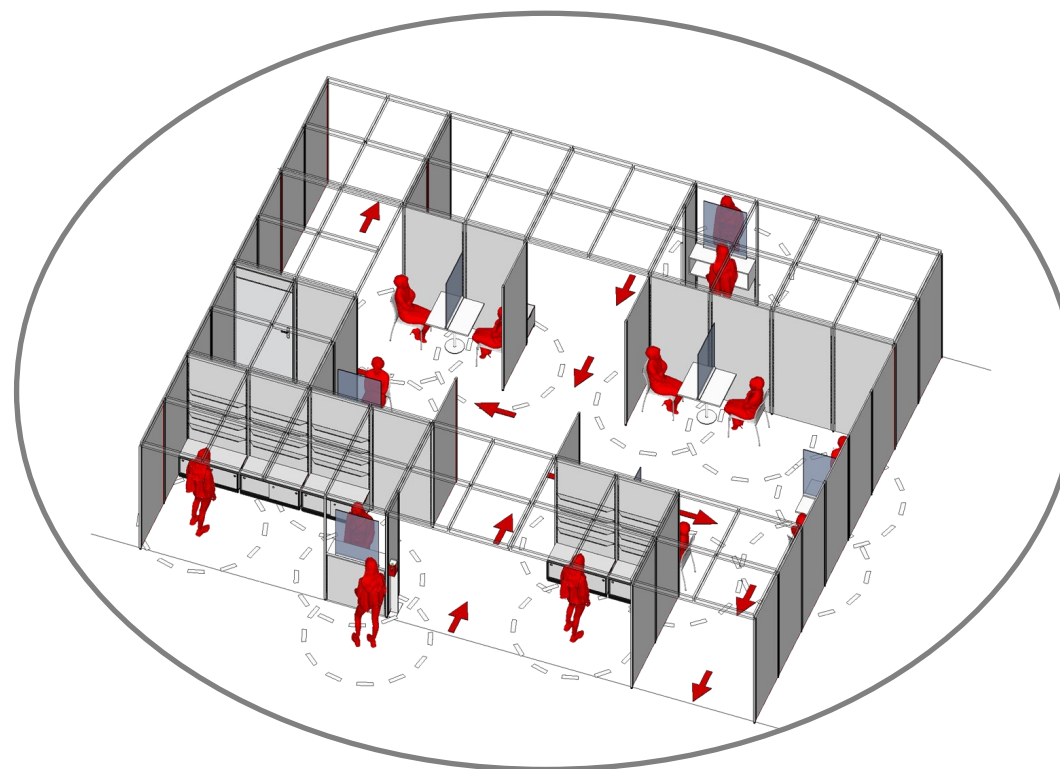
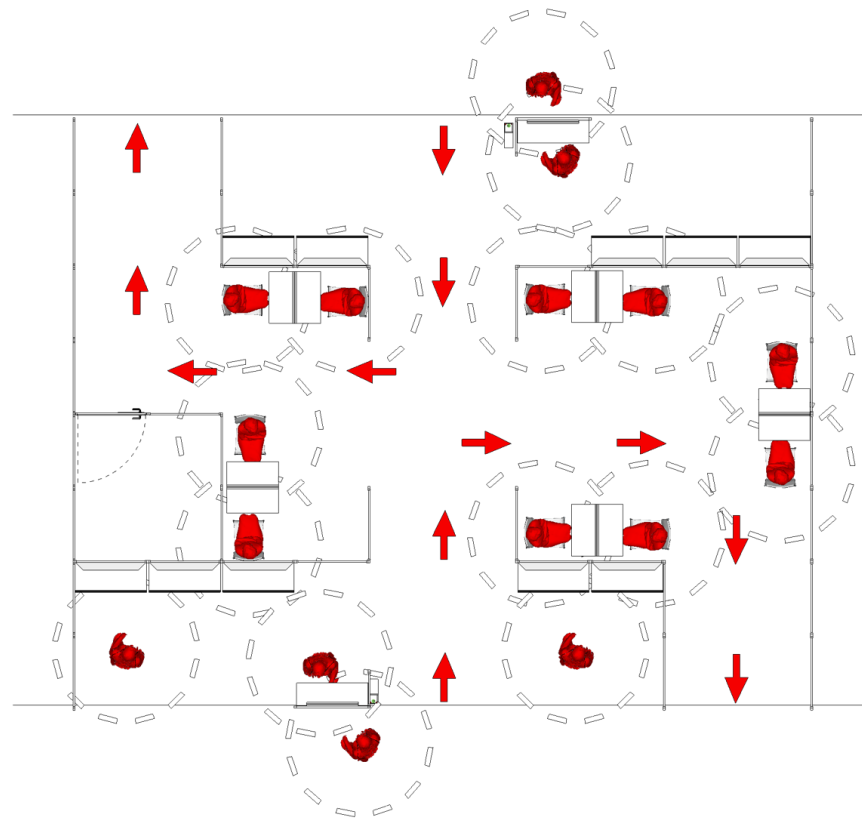

- 10 bench cabinets
- 40 book shelves
- 1 cubicle 2 m x 2 m (furniture & extras)
- 1 half-open wall (2 m) with a hanging shelf that can be used as a reception/counter (furniture & extras)
+ 2 protective screens (which can be booked via the service contractor)
- 3 tables with 2 chairs each, 10 spotlights (= package XXL)
+ 2 tables with 2 chairs each, 8 spotlights (= package XL)
+ 5 protective screens (which can be booked via the service contractor)
+ 6 additional spotlights (= 3x package XS)
- Marking of stand entrance and exit (via floor markings or signage)

max. number of people on the stand: 22

20.) Peninsula stand 96 sqm (8 m x 12 m) with 1 m x 1 m cubicle

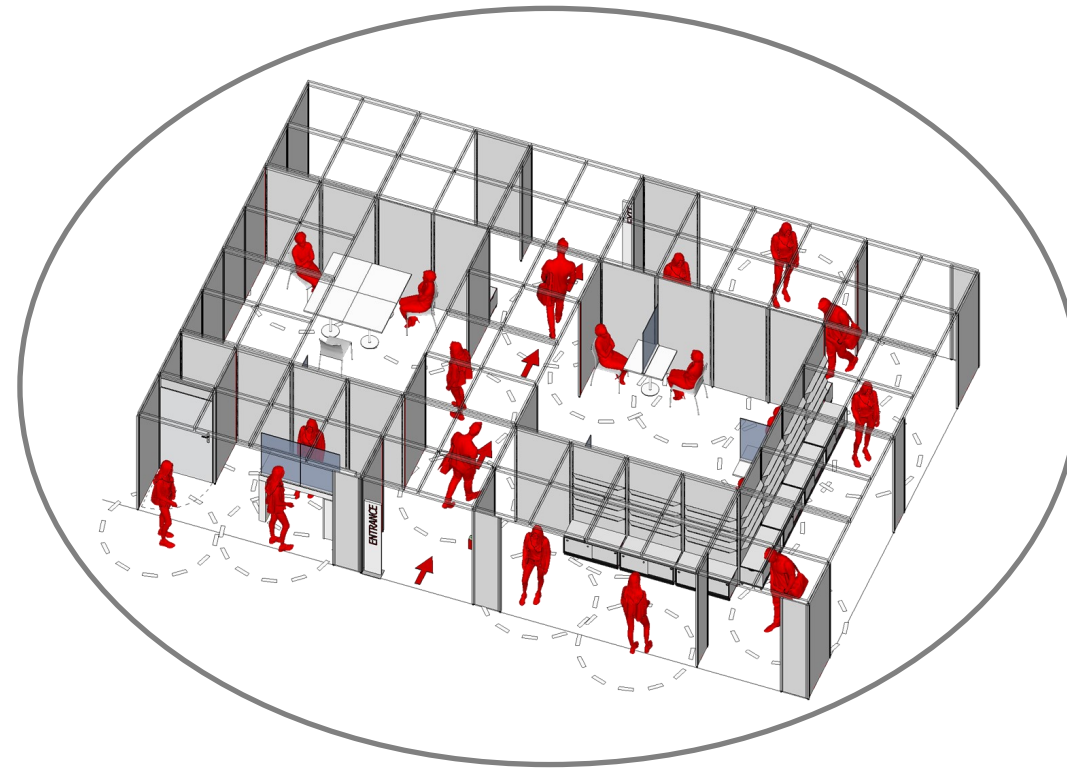
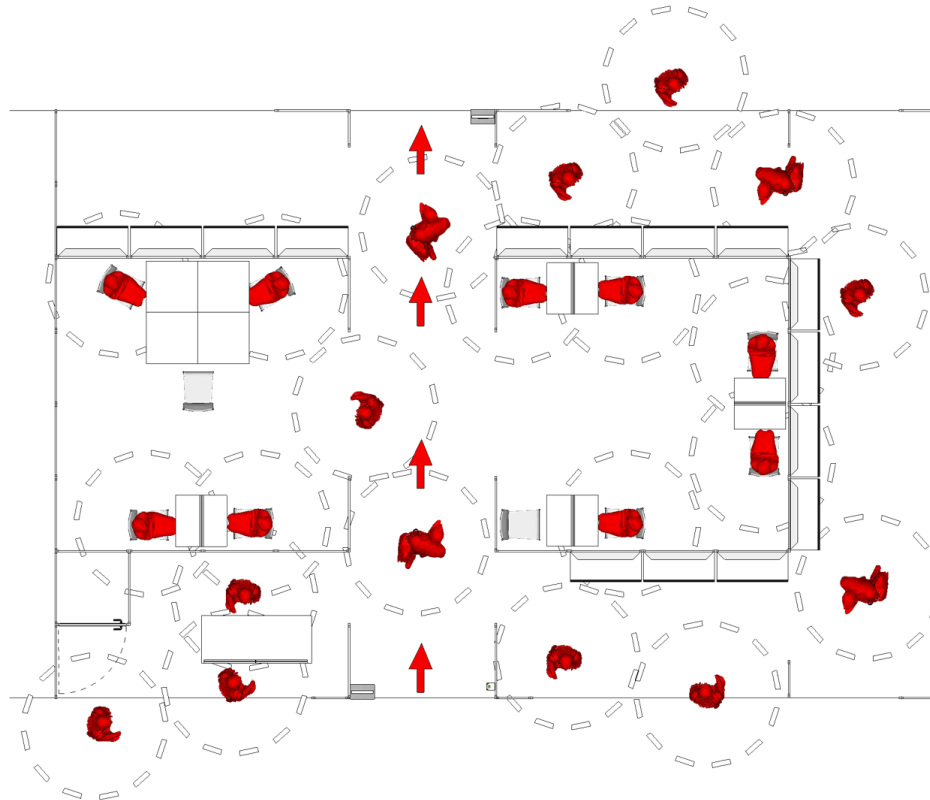

- 15 bench cabinets
- 60 book shelves
- 1 cubicle 1 m x 1 m (furniture & extras)
- 1 counter 1.5 m (furniture & extras)
+ 2 protective screens (which can be booked via the service contractor)
- 3 tables with 2 chairs each, 10 spotlights (= package XXL)
+ 2 tables with 2 chairs each, 8 spotlights (= package XL)
+ 3 additional tables, 1 chair (can be ordered via the service contractors)
+ 4 protective screens (which can be booked via the service contractor)
+ 18 additional spotlights (= 9x package XS)
- Marking of stand entrance and exit (via floor markings or signage)

max. number of people on the stand: 27

21.) Peninsula stand 96 sqm (8 m x 12 m)

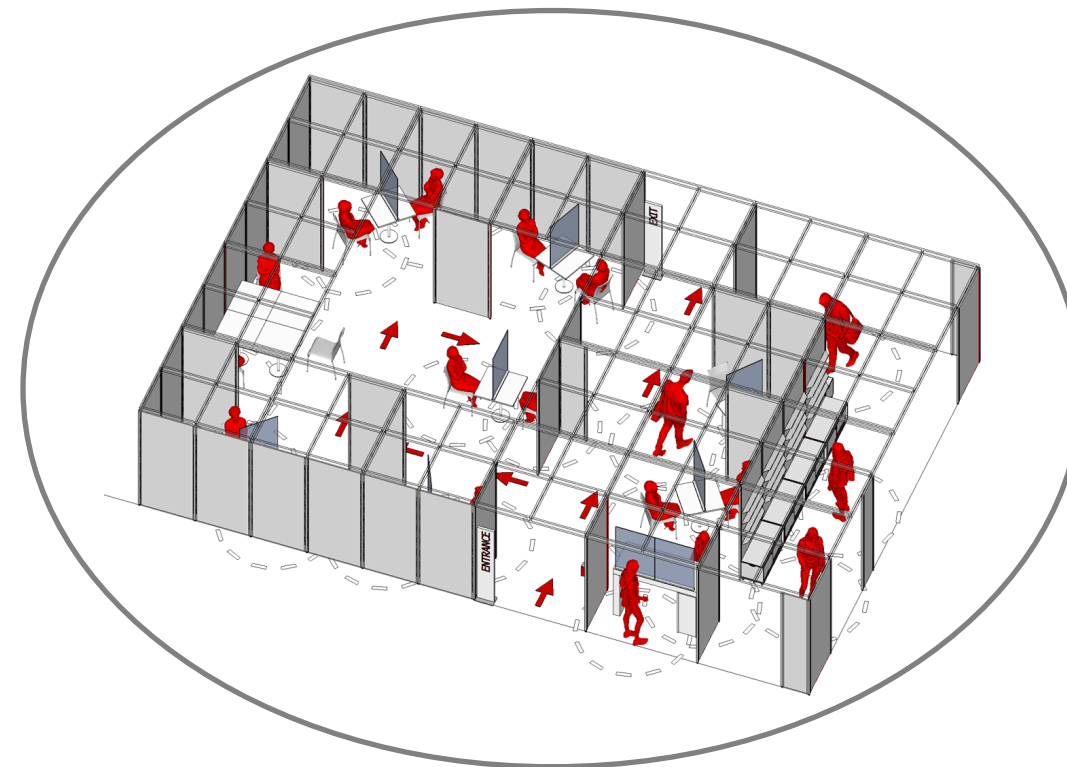
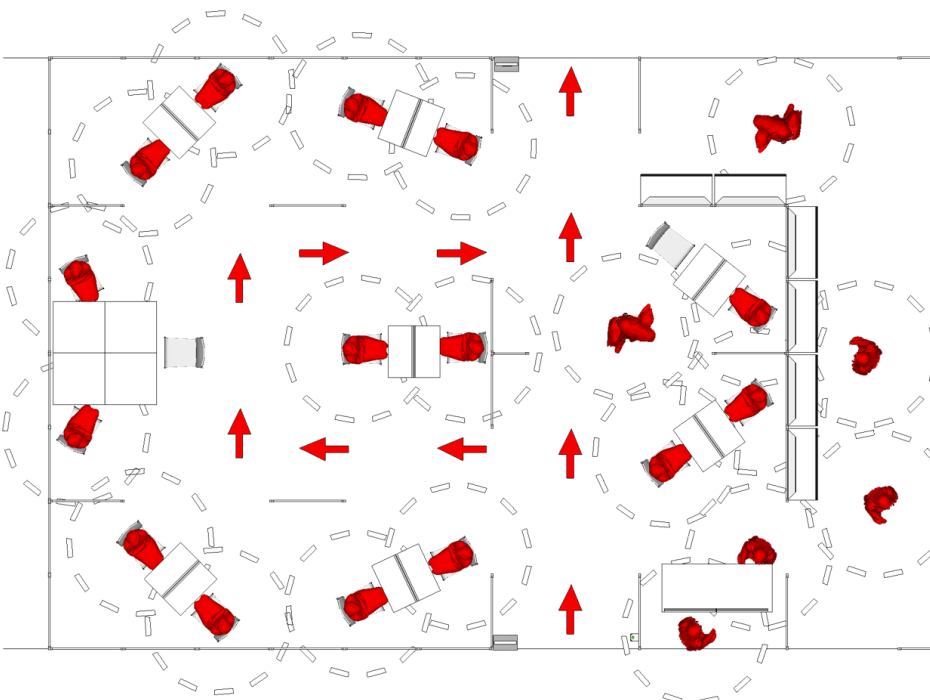

- 6 bench cabinets
- 24 book shelves
- 1 counter 1.5 m (furniture & extras)
+ 2 protective screens (which can be booked via the service contractor)
- 6 tables with 2 chairs each, 20 spotlights (= 2x package XXL)
+ 2 tables with 2 chairs each, 8 spotlights (= package XL)
+ 3 additional table, 1 chair (can be ordered via the service contractors)
+ 7 protective screens (which can be booked via the service contractor)
+ 12 additional spotlights (= 6x package XS)
- Marking of stand entrance and exit (via floor markings or signage)

max. number of people on the stand: 27